



DARTRONICS, INC.

PACKAGING AUTOMATION SPECIALISTS



247/248

Fully-Automatic High Speed Case Erectors



Servo Driven

While allowing the machine to reach higher speeds - up to 30 cases per minute - the servo drive system permits greater flexibility and control by allowing almost instant acceleration and deceleration of cases through the erecting process. In turn this system can save energy because the servo drives only use power when needed.



Low Cost of Ownership

The Endline 247 & 248 Case Erectors are designed to give you the best possible value for your investment. Our unique set of features and benefits means you will gain the maximum productivity with minimal stoppage time for problem-solving or case size changes.



Dual Opposing Vacuum Case Opening

This unique design feature ensures that each case is opened positively from both sides. It ensures the efficient and reliable opening of cases, and overcomes problems that can be associated with stiff board and glue migration from the manufacturer's joint.



Easy to Use

The 247 & 248 are designed with clear access, simple controls and quick to adjust to size changes. The machines are operator friendly and allow for quick and easy size change, cleaning and maintenance to ensure minimal machine downtime.



Clear Access

Simple mechanical operation and clear access for easy size change, cleaning and maintenance.



Robust Construction

Built with high quality components and housed in a robustly designed chassis, the 247 & 248 are robust enough to withstand the rigours of typical 24-hour end-of-line packaging environments.





247 & 248

Fully-Automatic
High Speed
Case Erectors

Options include:

- Low hopper sensing
- Low tape and no tape sensing
- Low glue sensing
- Visual audible failure alarm

247 dimensions shown

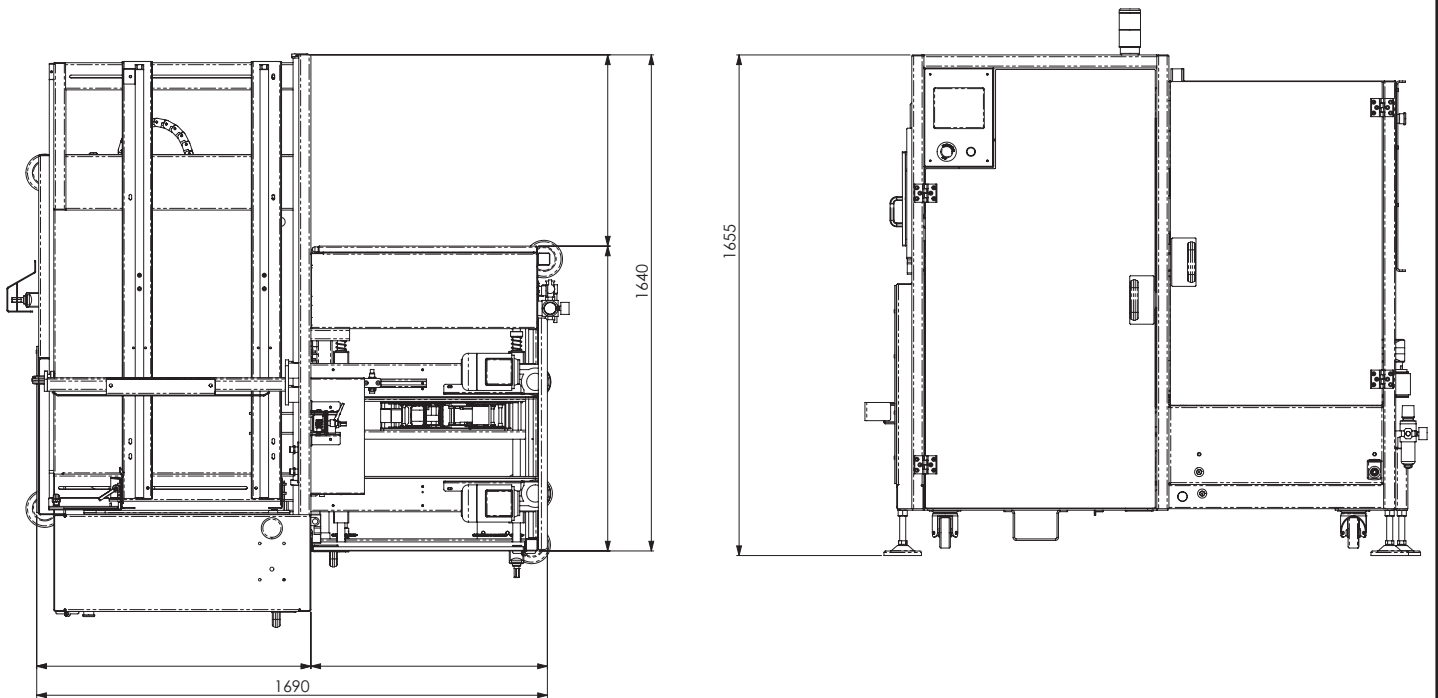

Note:

- The 247 case erector seals cases with self-adhesive tape.
- The 248 case erector seals cases with hot melt glue.
- Case speeds subject to case size.
- Machine can be modified for cases outside case size range. Please contact Endline to advise.

Case Dimensions (mm).

| | Length | Width | Height (Open) |
|-----------------|--------|-------|---------------|
| 247/248 Minimum | 160 | 100 | 150 |
| Maximum | 400 | 300 | 400 |

Speed

- Up to 25 cases per minute

Pneumatics

- 200 litres/min (5.5 bar) (19.5 litres/cycle)

Electrical Supply

- Type 247 Three phase: 380 - 415V, 50Hzv

- Type 248 Three phase: 380 - 415V, 50Hz

Tape Size (Type 247)

- Standard: up to 50mm wide

Machine Finish

- Mild steel, powder coated white (RAL 9010) or stainless steel

© Endline reserves the right to change specifications without prior notice.



Distributed by

DARTRONICS, INC.

PACKAGING AUTOMATION SPECIALISTS



Dartronics, Inc.

150 William Street, Perth Amboy NJ 08861

Phone: 732.324.0800 Fax: 732.324.4488 Toll Free: 1.800.298.8936 E-mail: sales@dartronics.com

